

Maps ©2015 Google 200 m

One Kingdom Street
Paddington Central
London W2 6BD
United Kingdom
Tel: +44(0)203 755 0974



Leading healthcare terminology, worldwide

Visiting One Kingdom Street

Main visitor reception is on the ground floor ('Podium' level) of the building. When you arrive at the ground floor front desk you'll be asked to sign in, before heading up to the 4th floor reception (for Regus offices) who will provide you with our office key if necessary. The Regus receptionist can help you with any deliveries, admin (printing, binding), and a call handling service. They can also assist with booking taxis if required.

Travelling by car, bicycle, motorbike or taxi

One Kingdom Street has underground parking at -2 level, which includes spaces for bicycles and motorbikes, as well as a visitor car parking bay for us to use at a daily rate of £25 plus VAT per day. You will need to provide a minimum of 7 days notice to concierge to book it. Due to the building being new, Paddington Station is a better reference when using Sat Nav - W2 1HB.

If you are travelling from the east, exit the A40 after crossing the A5 Edgware Road. This will bring you down onto a large roundabout on Harrow Road. This roundabout has gardens in the middle of it and half of it is under the A40. Ahead you'll see Bishop's Bridge. Keep this on your left, pass Travis Perkins builders' merchants and take the next exit rising up under the A40. You'll then arrive onto another roundabout. Take the second exit, which leads to the PaddingtonCentral access road and the -2 level for One Kingdom Street, which has a manned security barrier.

If travelling from the West, exit the A40 signposted for West London, cross Westbourne Bridge with the PaddingtonCentral site on your left. Take the next left into Bishop's Bridge Road and cross Bishop's Bridge to the roundabout with gardens in the middle which will be facing you. Turn left passing Travis Perkins builders' merchants which will be on your left and follow the directions as above from this point.

Two of the closest public car parks are the Paddington Station (Apcoa) on Bishop's Bridge Road and the Colonnades (NCP) in Porchester Terrace North. Taxi access to PaddingtonCentral is directly off Bishop's Bridge on Bishop's Bridge Road.

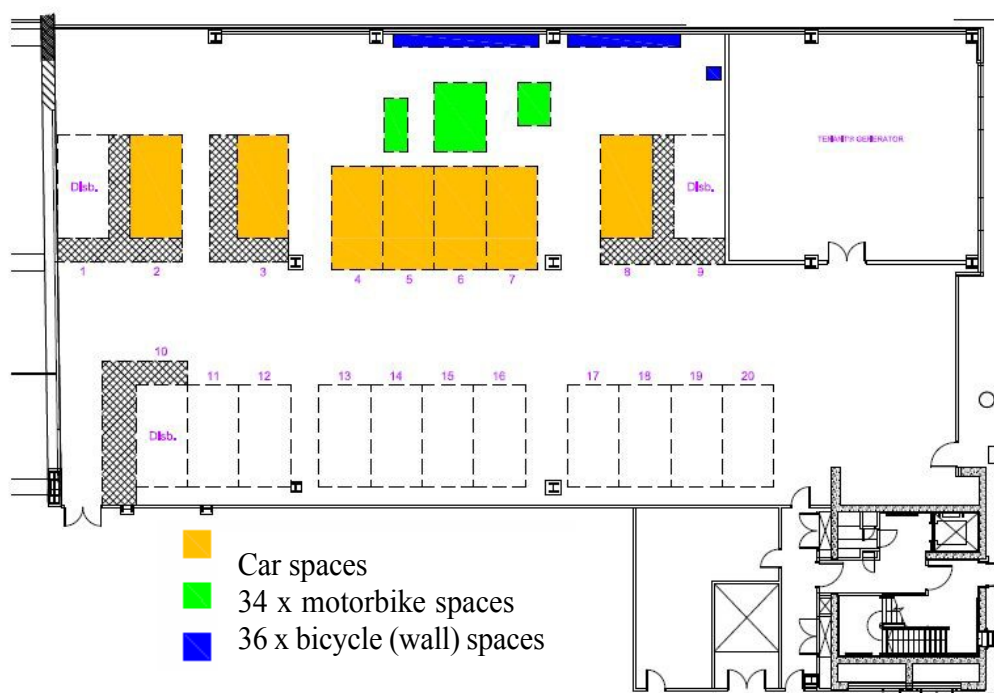
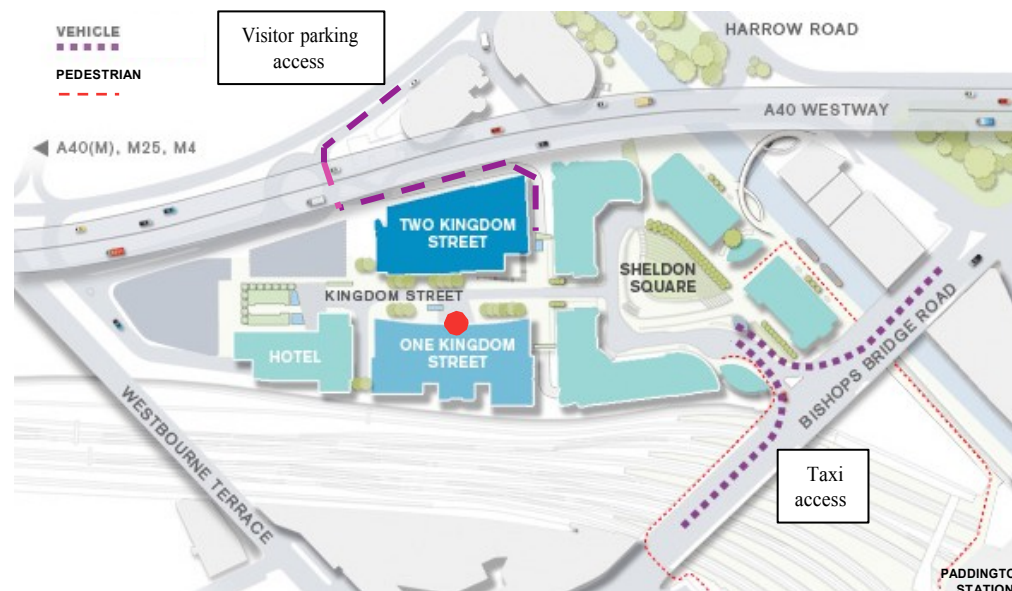

-2 level of One Kingdom Street showing visitor parking spaces

On Foot

From Paddington Station

Head for the footbridge over the tracks which is accessible from a number of the platforms (platform 8 being one of them). Go up the steps, turn right (left if coming from the Hammersmith & City tube line) and continue along the walkway following the PaddingtonCentral signs. These will lead you left alongside a towpath with the canal on your right. At Starbucks, turn left between two large buildings into Sheldon Square. Head straight on, passing the grass amphitheatre and shops on your right-hand side. Keep going until you reach Kingdom Street. One Kingdom Street is the large blue building half-way along on your left.

From Bishop's Bridge

Sheldon Square and Kingdom Street can be accessed directly from Bishop's Bridge by following the signs to PaddingtonCentral.

From Harrow Road

Walk across the new pedestrian bridge alongside the Porteus Road subway and the Travis Perkins Yard into the PaddingtonCentral development, following the signs.

By plane, train, tube or bus

PaddingtonCentral has good connecting services for most main airports:
Heathrow **15 mins every 15 mins** (Heathrow Express from Paddington)
Gatwick **45 mins** (via Victoria)
City Airport **40 mins** (via DLR from Tower Hill)
Luton **45 mins** (via King's Cross)
Stansted **60 mins** (via Liverpool Street)

Paddington Station is the main terminus for the West, including Newbury, which is just under an hour away on the fast service. For details visit www.nationalrail.co.uk. There are also direct connections for the Bakerloo, Hammersmith & City, Circle and District lines. See www.tfl.gov.uk for more information on London train, tube and bus services.

Direct connections / average journey times in minutes from Paddington



Mainline / Underground lines operating from Paddington Station

